

TIMKEN 65RIU249参数

轴承型号	Part Number	65RIU249		-
	Subtype	NU		-
尺寸	d	165.1	mm	内径
	D	330.2	mm	外径
	B	63.5	mm	宽度
额定载荷	C1	849610	N	一百万转动态径向载荷
	C0	876300	N	静态额定载荷
几何结构系数	Cg	0.1685		几何系数
极限转速	oil	2200		润滑油
	grease	1700		润滑脂
尺寸	R	5.08	mm	最大轴肩倒角半径
	da	196.85	mm	轴肩直径
	r	5.08	mm	最大轴承座挡肩圆角半径
	Da	298.45	mm	轴承座挡肩直径
重量	Assembly Weight	27669.13	g	-

TIMKEN 65RIU249图片

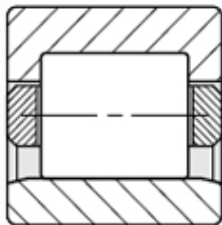
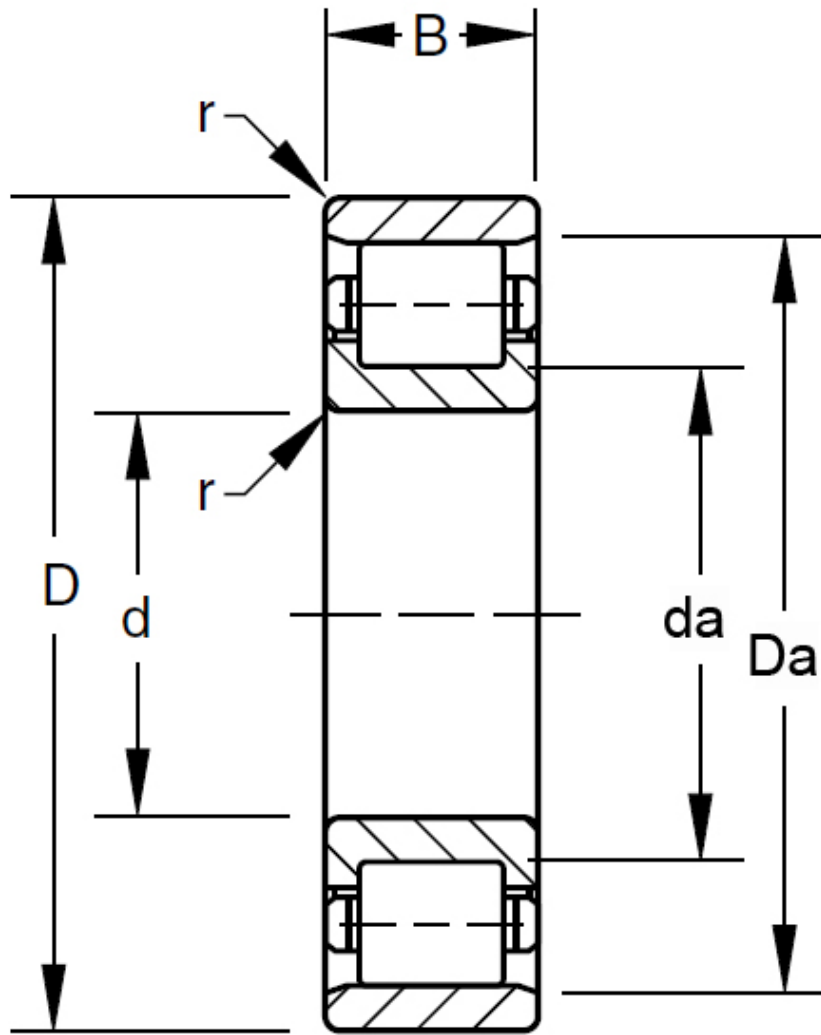

RU
RIU

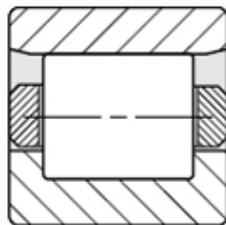

RN
RIN

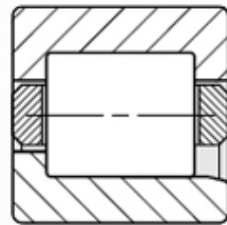

RJ
RIJ

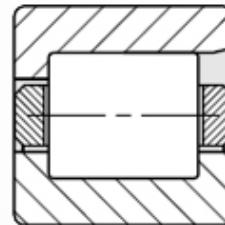

RF
RIF

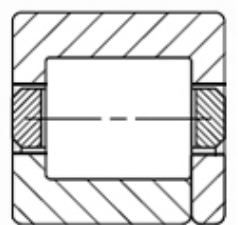

RT
RIT

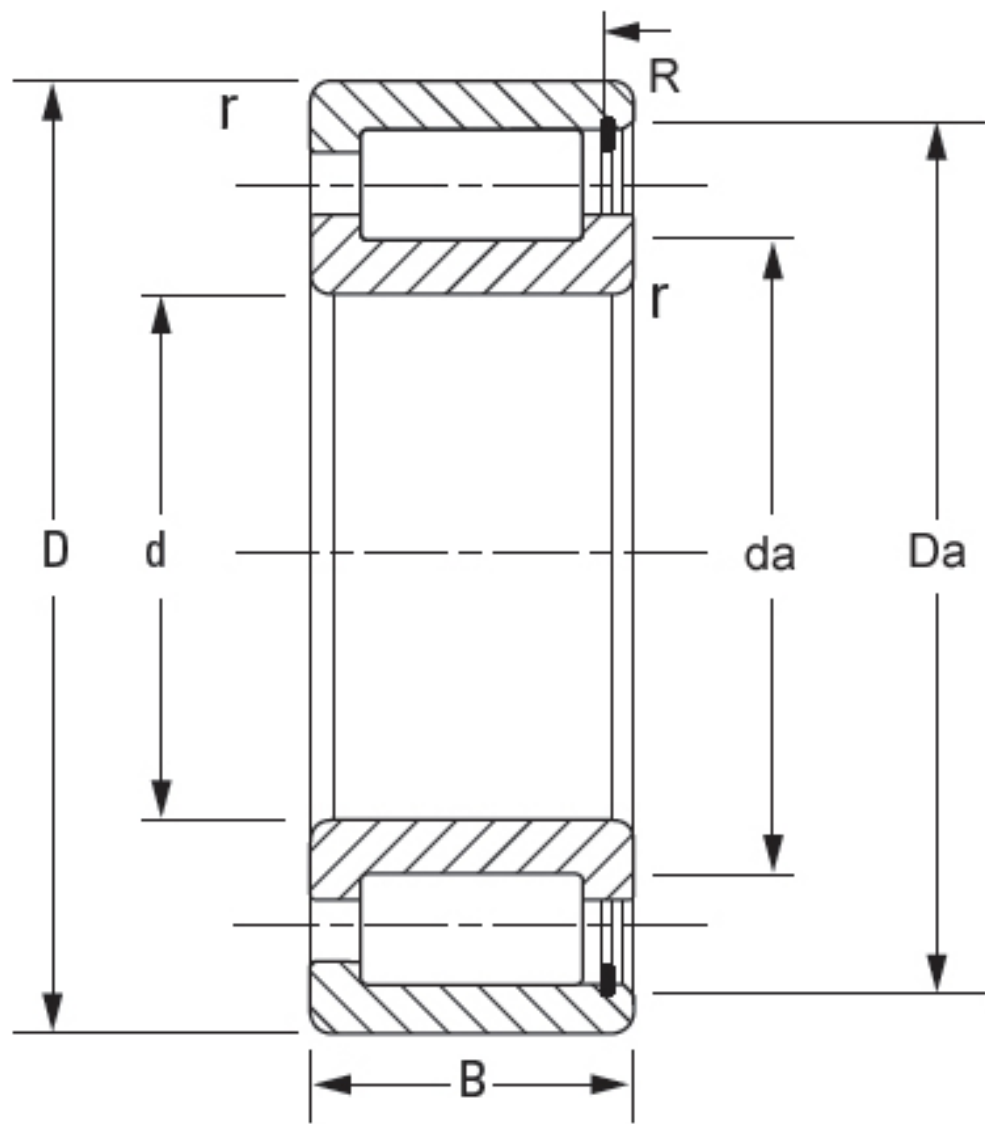

NCF